

SIII SERIES

Multiple upgrades were forged into one







430-445_w



● SIII SERIES

Seraphim redefined the high-efficiency module series by integrating 166mm silicon wafers with multi-busbar and half-cut cell technologies. Seraphim panel combined creative technology effectively and extremely improved the module efficiency and power output.

● KEY FEATURES

-  Less mismatch to get more power
-  Less power loss by minimizing the shading impact
-  Competitive low light performance
-  3 times EL test to ensure best quality
-  Ideal choice for utility and commercial scale projects by reduced BOS and improve ROI.
-  Outstanding reliability proven by PVEL for stringent environment condition :
 · 2400pa wind load and 5400pa snow load.

● QUALITY SYSTEM

ISO19001 / ISO14001 / OHSAS18001

● PRODUCT CERTIFICATION



● INSURANCE

PICC

● WARRANTY

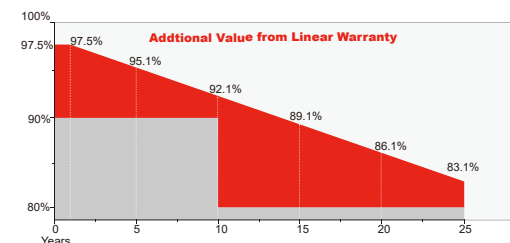

Guarantee on product material and workmanship



linear power output warranty



Electrical Characteristics

Module Type	SRP-430-BMA-HV		SRP-435-BMA-HV		SRP-440-BMA-HV		SRP-445-BMA-HV	
	STC	NOCT	STC	NOCT	STC	NOCT	STC	NOCT
Maximum Power at STC (Pmp)	430	320	435	324	440	328	445	332
Open Circuit Voltage (Voc)	49.4	46.1	49.6	45.3	49.7	45.4	49.9	45.6
Short Circuit Current (Isc)	11.11	8.95	11.18	9.02	11.27	9.10	11.34	9.17
Maximum Power Voltage (Vmp)	41.1	38.0	41.3	38.2	41.4	38.3	41.6	38.5
Maximum Power Current (Imp)	10.47	8.43	10.54	8.49	10.63	8.57	10.70	8.63
Module Efficiency at STC(ηm)	19.78		20.01		20.24		20.47	
Power Tolerance	(0, +3%)							
Maximum System Voltage	1000 V DC							
Maximum Series Fuse Rating	20 A							

STC: Irradiance 1000 W/m² module temperature 25°C AM=1.5
 Power measurement tolerance: +/-3%; Voltage measurement tolerance: +/-2%; Current measurement tolerance: +/-4%
 NOCT: Irradiance 800 W/m² ambient temperature 20°C wind speed :1m/s
 Power measurement tolerance: +/-3%; Voltage measurement tolerance: +/-2%; Current measurement tolerance: +/-4%

Temperature Characteristics

Pmax Temperature Coefficient	-0.35 %/°C
Voc Temperature Coefficient	-0.28 %/°C
Isc Temperature Coefficient	+0.05 %/°C
Operating Temperature	-40 ~ +85 °C
Nominal Operating Cell Temperature (NOCT)	45±2 °C

Mechanical Specifications

External Dimensions	2094 x 1038 x 35 mm
Weight	23.5 kg
Solar Cells	PERC Mono 166 x 83mm (144pcs)
Front Glass	3.2 mm AR coating tempered glass, low iron
Frame	Anodized aluminium alloy
Junction Box	IP68, 3 diodes
Output Cables	4.0 mm ² , Portrait:255mm(+)/355mm(-); Landscape:1200mm
Mechanical Load	Front side 5400Pa/ Rear side 2400Pa
Connector	Genuine MC4 / TT01 / TT02 / 05-6 / 05-8
Fire Safety Class	Class C

Packing Configuration

	2094 x 1038 x 35 mm	
Container	20'GP	40'HQ
Pieces per Pallet	31+4*	31+2*
Pallets per Container	5	22
Pieces per Container	175	726

* 31+4 and *31+2 pieces per pallet is the special package which only suits for container transport.
 For details, please consult SERAPHIM.

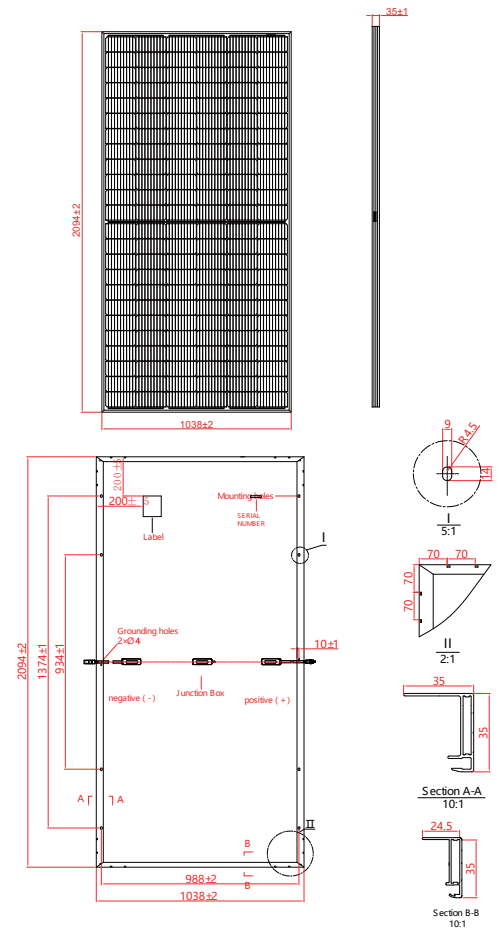

I-V Curve

