

SIV SERIES

Small Changes, Big Accomplishments

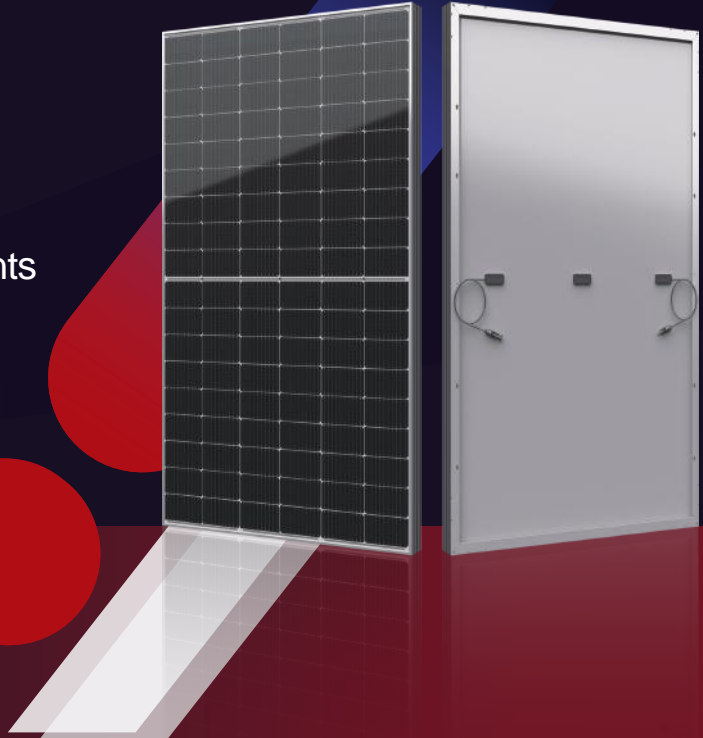



390-405w



• SIV SERIES

Seraphim redefined the high-efficiency module series by integrating 182mm silicon wafers with multi-busbar and half-cut cell technologies. Seraphim panel combined creative technology effectively and extremely improved the module efficiency and power output.

• KEY FEATURES

-  Less mismatch to get more power
-  Less power loss by minimizing the shading impact
-  Competitive low light performance
-  3 times EL test to ensure best quality
-  Ideal choice for utility and commercial scale projects by reduced BOS and improve ROI.

• QUALITY SYSTEM

ISO19001 / ISO14001 / OHSAS18001

• PRODUCT CERTIFICATION



• INSURANCE



• WARRANTY

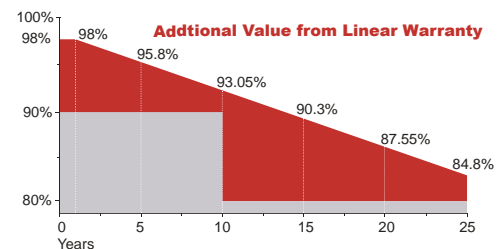

Guarantee on product material and workmanship



linear power output warranty



Electrical Characteristics

| Module Type | SRP-390-BMD-HV | SRP-395-BMD-HV | SRP-400-BMD-HV | SRP-405-BMD-HV |
|------------------------------|----------------|----------------|----------------|----------------|
| | STC | STC | STC | STC |
| Maximum Power at STC (Pmp) | 390 | 395 | 400 | 405 |
| Open Circuit Voltage (Voc) | 36.90 | 37.01 | 37.12 | 37.22 |
| Short Circuit Current (Isc) | 13.40 | 13.50 | 13.60 | 13.70 |
| Maximum Power Voltage (Vmp) | 30.59 | 30.69 | 30.81 | 30.93 |
| Maximum Power Current (Imp) | 12.78 | 12.88 | 12.99 | 13.10 |
| Module Efficiency at STC(ηm) | 20.17 | 20.42 | 20.68 | 20.94 |
| Power Sorting (W) | (0 ~ +4.99) | | | |
| Maximum System Voltage | 1500V DC | | | |
| Maximum Series Fuse Rating | 25 A | | | |

STC: Irradiance 1000 W/m² module temperature 25°C AM=1.5
 Power measurement tolerance: +/-3%; Voltage measurement tolerance: +/-2%; Current measurement tolerance: +/-4%

Temperature Characteristics

| | |
|---|--------------|
| Pmax Temperature Coefficient | -0.35 %/°C |
| Voc Temperature Coefficient | -0.28 %/°C |
| Isc Temperature Coefficient | +0.05 %/°C |
| Operating Temperature | -40 ~ +85 °C |
| Nominal Operating Cell Temperature (NOCT) | 45±2 °C |

Mechanical Specifications

| | |
|---------------------|--|
| External Dimensions | 1707 x 1133x 35 mm |
| Weight | 21 kg |
| Solar Cells | PERC Mono (108pcs) |
| Front Glass | 3.2 mm AR coating tempered glass, low iron |
| Frame | Anodized aluminium alloy |
| Junction Box | IP68,3 diodes |
| Output Cables | 4.0 mm ² , Portrait:255mm(+)/355mm(-); Landscape:1200mm |
| Mechanical Load | Front side 5400Pa/ Rear side 2400Pa |
| Connector | Genuine MC4 EVO2/ TT02 / 05-8 |
| Fire Safety Class | Class C |

Packing Configuration

| | 1707 x 1133x 35 mm | |
|-----------------------|--------------------|-------|
| Container | 20'GP | 40'HQ |
| Pieces per Pallet | 31*4 | 31 |
| Pallets per Container | 6 | 26 |
| Pieces per Container | 210 | 806 |

* 31+4 pieces per pallet is the special package which only suits for container transport.
 For details, please consult SERAPHIM.

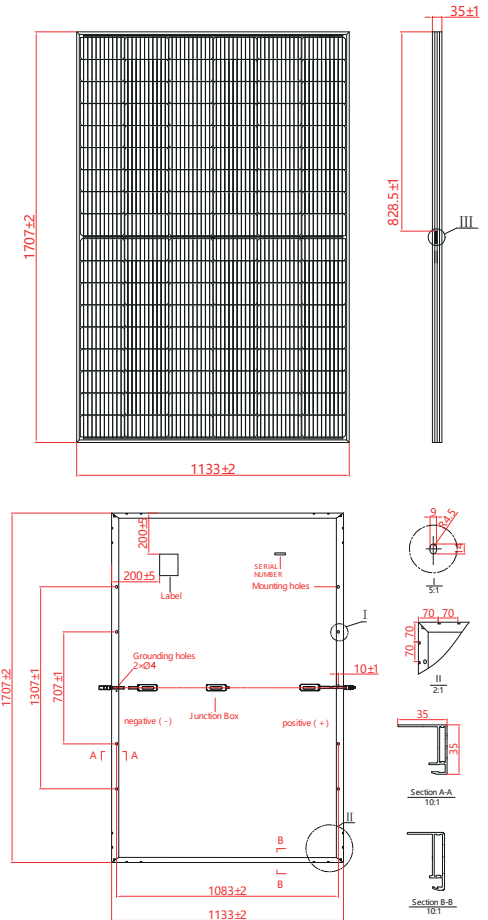

I-V Curve

